

# RoHS Compliant

ITEM	PART NUMBER	PART NAME	Q'TY	MATERIAL
1	11-0003-350	PLASTIC BODY	1	LCP+30%GF
2	22-1011-350	CONTACT	3	BE-CU
3	11-0001-350	COVER	1	PAGT+30%GF

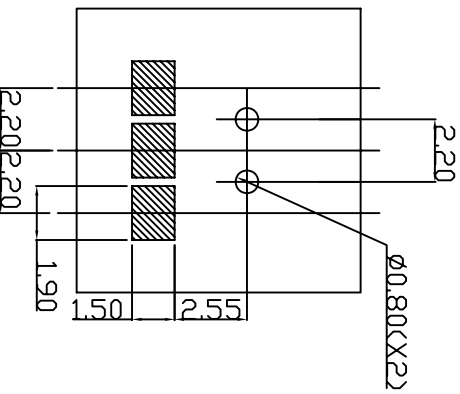
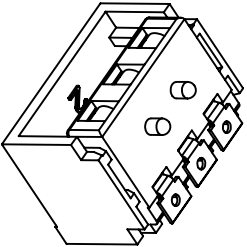
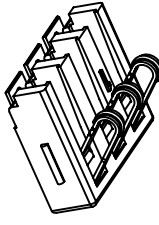
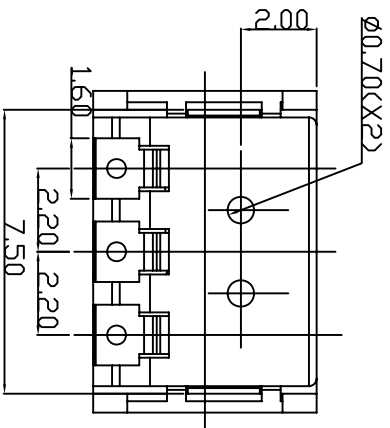
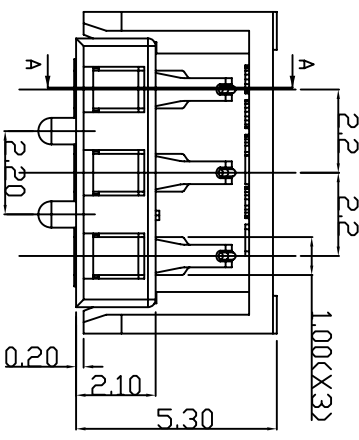
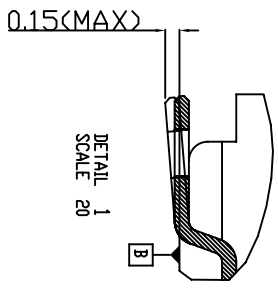
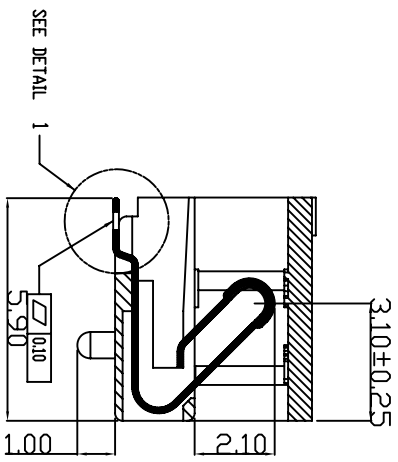
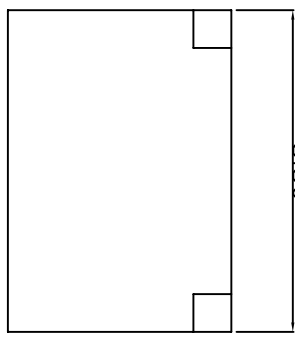

NOTES:  
 1.THE CONTACT MATERIAL THICKNESS:0.15mm.  
 FINISH: GOLD 3 u" IN SOLDER END(MIN).  
 CONTACT AREA IS GOLD PLATED 10u"(MIN).  
 ALL UNDERPLATED SOU DUCTILE NICKEL(MIN).  
 2.SPRING WORKING STROKE:1.60mm

SCALE	UNIT	DRAWN BY	DATE
1:1	MM	Rain	06/01/20
SIZE	CHECKED BY	DATE	TITLE
	Rein	06/01/20	Battery Connector H=4.2
	APPROVED BY	DATE	
	Chain	06/01/20	

GENERAL TOLERANCES  
(UNLESS SPECIFIED)

X. ± 0.40 X'. ± 2.  
 .X ± 0.30 .X'. ± 1.  
 .XX ± 0.15 .X'. ± 1.

**CMK**  
**Comtek Electronics**

PART NO. 8190-11003002-200  
 DRAWING NO. 8190-11003002-200-AQ  
 FINISH SEE NOTE  
 SEE NOTE

SHEET 1 OF 1  
 REV A0

REV.	REVISION NOTE	DATE